

NordicFlow® Stainless Steel Grooved Tees



Description

Grooved tees made from acid resistant stainless steel.

Materials

Body: Type CF8M (316) stainless steel ASTM A351, A743 or A744 Gr. CF-8

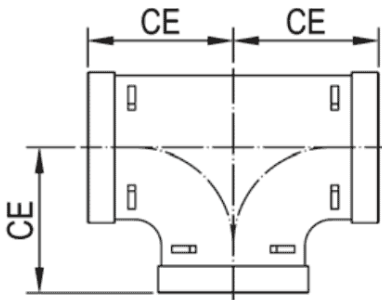

Dimensions

Product code	Size (")	DN (mm)	O.D. (mm)	CE (mm)	Weight (kg)
T1SS-033*	1	25	33,7	57	0,3
T1SS-042*	1¼	32	42,4	70	0,5
T1SS-048	1½	40	48,3	70	0,6
T1SS-060	2	50	60,3	70	0,8
T1SS-076	2½	65	76,1	76	1,1
T1SS-089	3	80	88,9	86	1,4
T1SS-114	4	100	114,3	102	2,2
T1SS-140	5	125	139,7	124	3,6
T1SS-168	6	150	168,3	140	4,9
T1SS-219	8	200	219,1	173	9,8
T1SS-273*	10	250	273	229	20
T1SS-324*	12	300	323,9	254	30

* Not a stock product, confirm delivery time

Note:

- Enexia Oy reserves the right to change specifications, designs and/or standard equipment without notice and without incurring in any obligations.